

THOMASVILLE II - ELEVATION B

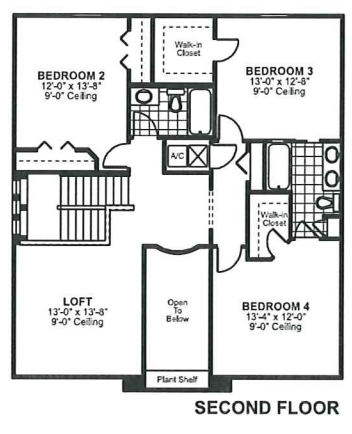

*Thomasville II Elevation B Three Car Garage*

Total Living Area .....3332 SF

Garage.....680 SF

Entry Porch.....153 SF

Porte Cochere.....360 SF

Lanai.....192 SF

**Total Under Roof .....4717 SF**

*In the interest of continuous improvement, Southern Heritage Neighborhoods reserves the right to change or modify floor plans, materials and included features without prior notice or obligations. All floor plans and exterior rendering are artist's conceptions and all dimensions are approximate. Artist's renderings are shown with optional exterior finishes; such as, stone, brick, and Hardy Board exteriors. CGC959338*